

# First Aid policy

Diss High School



<b>Approved by:</b>	Sam Stopps	<b>Date:</b> 3.12.24
<b>Last reviewed on:</b>	3.12.24	
<b>Next review due by:</b>	3.12.25	

## Contents

1. Aims .....	2
2. Legislation and guidance .....	2
3. Roles and responsibilities .....	3
4. First aid procedures .....	4
5. First aid equipment .....	5
6. Record-keeping and reporting .....	5
7. Training .....	7
8. Monitoring arrangements .....	7
9. Links with other policies .....	7
Appendix 1: list of first aid trained .....	8
Appendix 2: accident report form – Now held on Smartlog .....	9
Appendix 3: first aid training log – Now held on Smartlog .....	9

---

## 1. Aims

The aims of our first aid policy are to:

- Ensure the health and safety of all staff, pupils and visitors
- Ensure that staff and governors are aware of their responsibilities with regards to health and safety
- Provide a framework for responding to an incident and recording and reporting the outcomes

## 2. Legislation and guidance

- [The Health and Safety \(First-Aid\) Regulations 1981](#), which state that employers must provide adequate and appropriate equipment and facilities to enable first aid to be administered to employees, and qualified first aid personnel
- [The Management of Health and Safety at Work Regulations 1992](#), which require employers to make an assessment of the risks to the health and safety of their employees
- [The Management of Health and Safety at Work Regulations 1999](#), which require employers to carry out risk assessments, make arrangements to implement necessary measures, and arrange for appropriate information and training
- [The Reporting of Injuries, Diseases and Dangerous Occurrences Regulations \(RIDDOR\) 2013](#), which state that some accidents must be reported to the Health and Safety Executive (HSE), and set out the timeframe for this and how long records of such accidents must be kept
- [Social Security \(Claims and Payments\) Regulations 1979](#), which set out rules on the retention of accident records

- [The Education \(Independent School Standards\) Regulations 2014](#), which require that suitable space is provided to cater for the medical and therapy needs of pupils

This policy complies with our funding agreement and articles of association.

### 3. Roles and responsibilities

In all settings – and dependent upon an assessment of first aid needs – employers must usually have a sufficient number of suitably trained first aiders to care for employees in case they are injured at work. However, the minimum legal requirement is to have an ‘appointed person’ to take charge of first aid arrangements, provided your assessment of need has taken into account the nature of employees’ work, the number of staff, and the layout and location of the school. The appointed person does not need to be a trained first aider.

Section 3.1 below sets out the expectations of appointed persons and first aiders as set out in the 1981 first aid regulations and the DfE guidance listed in section 2.

#### 3.1 Appointed person(s) and first aiders

The school’s appointed persons are as per appendix 1 They are responsible for:

- Taking charge when someone is injured or becomes ill
- Ensuring there is an adequate supply of medical materials in first aid kits, and replenishing the contents of these kits
- Ensuring that an ambulance or other professional medical help is summoned when appropriate

First aiders are trained and qualified to carry out the role (see section 7) and are responsible for:

- Acting as first responders to any incidents; they will assess the situation where there is an injured or ill person, and provide immediate and appropriate treatment
- Sending pupils home to recover, where necessary
- Filling in an accident report on the same day as, or as soon as is reasonably practicable, after an incident (see the template in appendix 2)
- Keeping their contact details up to date

Our school’s first aiders are listed in appendix 1. Their names will also be displayed prominently around the school site.

#### 3.2 The governing board

The governing board has ultimate responsibility for health and safety matters in the school, but delegates operational matters and day-to-day tasks to the headteacher and staff members.

#### 3.3 The headteacher

The headteacher is responsible for the implementation of this policy, including:

- Ensuring that an appropriate number of trained first aid personnel are present in the school at all times
- Ensuring that first aiders have an appropriate qualification, keep training up to date and remain competent to perform their role
- Ensuring all staff are aware of first aid procedures
- Ensuring appropriate risk assessments are completed and appropriate measures are put in place
- Undertaking, or ensuring that managers undertake, risk assessments, as appropriate, and that appropriate measures are put in place

- Ensuring that adequate space is available for catering to the medical needs of pupils
- Reporting specified incidents to the HSE when necessary (see section 6)

### 3.4 Staff

School staff are responsible for:

- Ensuring they follow first aid procedures
- Ensuring they know who the first aiders in school are
- Completing accident reports (see appendix 2) for all incidents they attend to where a first aider is not called
- Informing the headteacher or their manager of any specific health conditions or first aid needs

## 4. First aid procedures

### 4.1 In-school procedures

In the event of an accident resulting in injury:

- The closest member of staff present will assess the seriousness of the injury and seek the assistance of a qualified first aider, if appropriate, who will provide the required first aid treatment
- The first aider, if called, will assess the injury and decide if further assistance is needed from a colleague or the emergency services. They will remain on the scene until help arrives
- The first aider will also decide whether the injured person should be moved or placed in a recovery position
- If the first aider judges that a pupil is too unwell to remain in school, parents/carers will be contacted and asked to collect their child. On their arrival, the first aider will recommend next steps to the parents/carers
- If emergency services are called, reception staff will contact parents/carers immediately
- The first aider will complete an accident report form on the same day or as soon as is reasonably practical after an incident resulting in an injury

### 4.2 Off-site procedures

When taking pupils off the school premises, staff will ensure they always have the following:

- A school mobile phone
- A portable first aid kit including, at minimum:

The following are based on the HSE's recommendation for a minimum travelling first aid kit

A leaflet giving general advice on first aid

- 6 individually wrapped sterile adhesive dressings
  - 1 large sterile unmedicated dressing
  - 2 triangular bandages – individually wrapped and preferably sterile
  - 2 safety pins
  - 1 individually wrapped moist cleansing wipe
  - 2 pairs of disposable gloves
- Information about the specific medical needs of pupils
  - Parents/carers' contact details

When transporting pupils using a minibus or other large vehicle, the school will make sure the vehicle is equipped with a clearly marked first aid box containing, at minimum:

- 10 antiseptic wipes, foil packed
- 1 conforming disposable bandage (not less than 7.5cm wide)
- 2 triangular bandages
- 1 packet of 24 assorted adhesive dressings
- 3 large sterile unmedicated ambulance dressings (not less than 15cm x 20 cm)
- 2 sterile eye pads, with attachments
- 12 assorted safety pins
- 1 pair of rustproof blunt-ended scissors

Risk assessments will be completed by the teacher responsible for the trip prior to any educational visit that necessitates taking pupils off school premises.

There will always be at least 1 first aider on school trips and visits.

## 5. First aid equipment

A typical first aid kit in our school will include the following:

The following is based on the HSE's recommendation for a minimum first aid kit

- A leaflet giving general advice on first aid
- 20 individually wrapped sterile adhesive dressings (assorted sizes)
- 2 sterile eye pads
- 2 individually wrapped triangular bandages (preferably sterile)
- 6 safety pins
- 6 medium-sized individually wrapped sterile unmedicated wound dressings
- 2 large sterile individually wrapped unmedicated wound dressings
- 3 pairs of disposable gloves

No medication is kept in first aid kits.

First aid kits are stored in:

- The medical room
- Also around the school site as per our school map

## 6. Record-keeping and reporting

### 6.1 First aid and accident record book

- An accident form will be completed by the first aider on the same day or as soon as possible after an incident resulting in an injury via Smartlog.
- As much detail as possible should be supplied when reporting an accident, including all of the information included in the accident form at appendix 2

For accidents involving pupils, a copy of the accident report form will also be added to the pupil's educational record by updating medical notes in Sims.

- Records held in the first aid and accident book will be retained by the school for a minimum of 3 years, in accordance with regulation 25 of the Social Security (Claims and Payments) Regulations 1979, and then securely disposed of.

## 6.2 Reporting to the HSE

The School Business Manager will keep a record of any accident that results in a reportable injury, disease, or dangerous occurrence as defined in the RIDDOR 2013 legislation (regulations 4, 5, 6 and 7).

The School Business Manager will report these to the HSE as soon as is reasonably practicable and in any event within 10 days of the incident – except where indicated below. Fatal and major injuries and dangerous occurrences will be reported without delay (i.e. by telephone) and followed up in writing within 10 days.

### **School staff: reportable injuries, diseases or dangerous occurrences**

These include:

- Death
- Specified injuries, which are:
  - Fractures, other than to fingers, thumbs and toes
  - Amputations
  - Any injury likely to lead to permanent loss of sight or reduction in sight
  - Any crush injury to the head or torso causing damage to the brain or internal organs
  - Serious burns (including scalding) which:
    - Covers more than 10% of the whole body's total surface area; or
    - Causes significant damage to the eyes, respiratory system or other vital organs
  - Any scalding requiring hospital treatment
  - Any loss of consciousness caused by head injury or asphyxia
  - Any other injury arising from working in an enclosed space which leads to hypothermia or heat-induced illness, or requires resuscitation or admittance to hospital for more than 24 hours
- Work-related injuries that lead to an employee being away from work or unable to perform their normal work duties for more than 7 consecutive days (not including the day of the incident). In this case, the school business manager will report these to the HSE as soon as reasonably practicable and in any event within 15 days of the accident
- Occupational diseases where a doctor has made a written diagnosis that the disease is linked to occupational exposure. These include:
  - Carpal tunnel syndrome
  - Severe cramp of the hand or forearm
  - Occupational dermatitis, e.g. from exposure to strong acids or alkalis, including domestic bleach
  - Hand-arm vibration syndrome
  - Occupational asthma, e.g. from wood dust
  - Tendonitis or tenosynovitis of the hand or forearm
  - Any occupational cancer
  - Any disease attributed to an occupational exposure to a biological agent
- Near-miss events that do not result in an injury, but could have done. Examples of near-miss events relevant to schools include, but are not limited to:

- The collapse or failure of load-bearing parts of lifts and lifting equipment
- The accidental release of a biological agent likely to cause severe human illness
- The accidental release or escape of any substance that may cause a serious injury or damage to health
- An electrical short circuit or overload causing a fire or explosion

**Pupils and other people who are not at work (e.g. visitors): reportable injuries, diseases or dangerous occurrences**

These include:

- Death of a person that arose from, or was in connection with, a work activity\*
- An injury that arose from, or was in connection with, a work activity\* and where the person is taken directly from the scene of the accident to hospital for treatment

\*An accident “arises out of” or is “connected with a work activity” if it was caused by:

- A failure in the way a work activity was organised (e.g. inadequate supervision of a field trip)
- The way equipment or substances were used (e.g. lifts, machinery, experiments etc); and/or
- The condition of the premises (e.g. poorly maintained or slippery floors)

Information on how to make a RIDDOR report is available here:

[How to make a RIDDOR report, HSE](http://www.hse.gov.uk/riddor/report.htm)

<http://www.hse.gov.uk/riddor/report.htm>

## 7. Training

All school staff are able to undertake first aid training if they would like to.

All first aiders must have completed a training course, and must hold a valid certificate of competence to show this. The school will keep a register of all trained first aiders, what training they have received and when this is valid until (see appendix 3).

The school will arrange for first aiders to retrain before their first aid certificates expire. In cases where a certificate expires, the school will arrange for staff to retake the full first aid course before being reinstated as a first aider.

## 8. Monitoring arrangements

This policy will be reviewed by the School Business Manager or PA to Headteacher every year.

At every review, the policy will be approved by Mr S Stopps and the Governing Board.

## 9. Links with other policies

This first aid policy is linked to the:

- Health and safety policy
- Risk assessment policy
- Policy on supporting pupils with medical conditions

## Appendix 1: list of first aid trained

STAFF MEMBER'S NAME	ROLE	CONTACT DETAILS
Stephen Archer	Teacher - First Aider	As per staff email
Emma Bensley	Teacher – First Aider	As per staff email
Mikela Bond	Teacher – First Aider	As per staff email
Samantha Budds	Teacher – First Aider	As per staff email
Simon Busby	Teacher and Dof E First Aider	As per staff email
Katherine Hawkes	Support staff – First Aider	As per staff email
Charlotte Jeffers	PE staff – First Aider	As per staff email
Christine Kelly	Teacher – First Aider	As per staff email
James Kemp	PE staff – First Aider	As per staff email
Clive Kitney	Science Tech – First Aider	As per staff email
Claire Lewis	Support staff – First Aider	As per staff email
Karen O'Neill	DSL – First Aider	As per staff email
Sara Palmer	TA – First Aider	As per staff email
Kieran Pearson	PE staff – First Aider	As per staff email
Elise Richmond	PE Staff – First Aider	As per staff email
Steph Self	Support Staff – First Aider	As per staff email
Duncan Somers	SLT – First Aider	As per staff email
Emma Somers	SENCO – First Aider	As per staff email
Rachel Thompson	Support staff – First Aider	As per staff email
Paula Turrell	Support staff – First Aider	As per staff email
Lindsey Vernon	Support staff – First Aider	As per staff email



Appendix 2: accident report form – Now held on Smartlog

Appendix 3: first aid training log – Now held on Smartlog

**Maps of First Aid boxes**

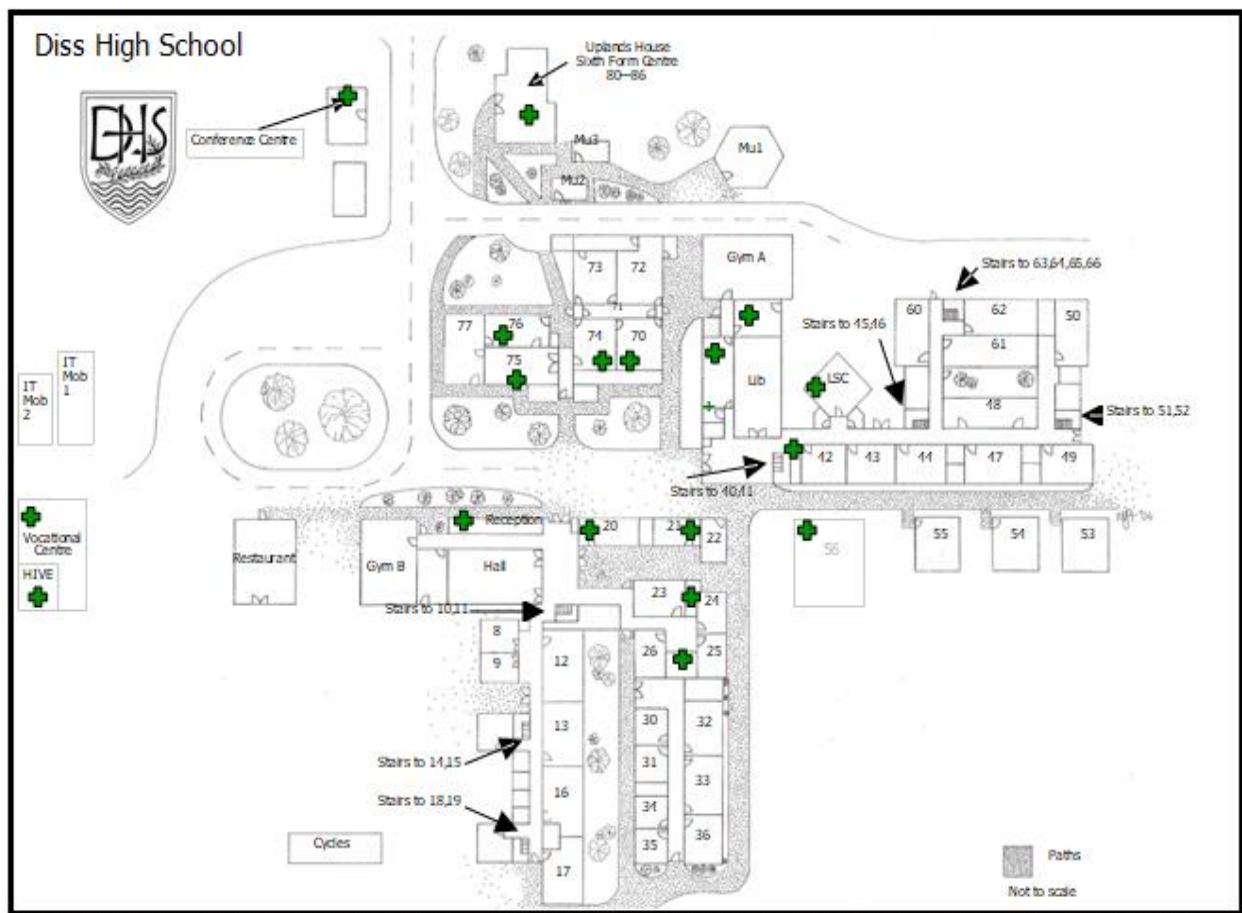

Location names

Room	Location of box within room
Boys PE	Office within the changing room
DT 74	Above the sink, diagonally

DT 70	Left side as coming from 74
Art 76	Shelf on left going towards door of 77
Art 75	Next to sink
Vocational Centre 1	Corner shelf unit
LSC Office	On top of filing cabinet
6th form office	Shelf on right of office door
Physics prep room	Left hand side on wall
Chemistry prep room	right hand side on wall
Food Tech 20	Shelf before exit to room 21
Food Tech 21	Near the board
Conference Centre	Kitchen
Minibuses	Front passenger
HIVE	Sink
Staff room	Above sink opposite door
Reprographics	Left hand side
Science Rm 56	
Medical room	Right hand side on filing cabinet

# Map of AED

